

**1** 1.83m NEW GATES & CONNECTION TO EXISTING FENCE  
1:50

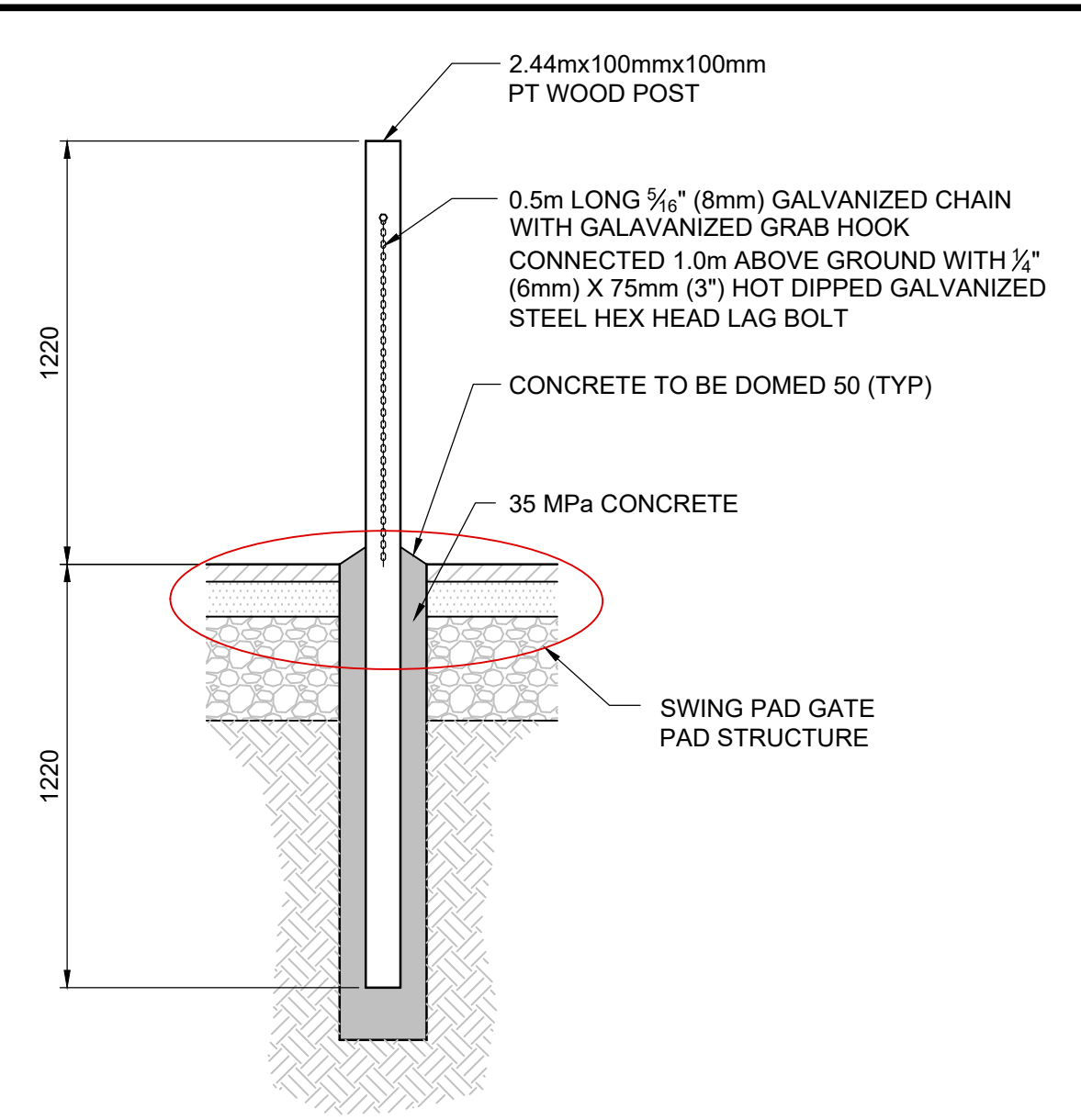

**2** GATE SECURE POST DETAIL  
1:20

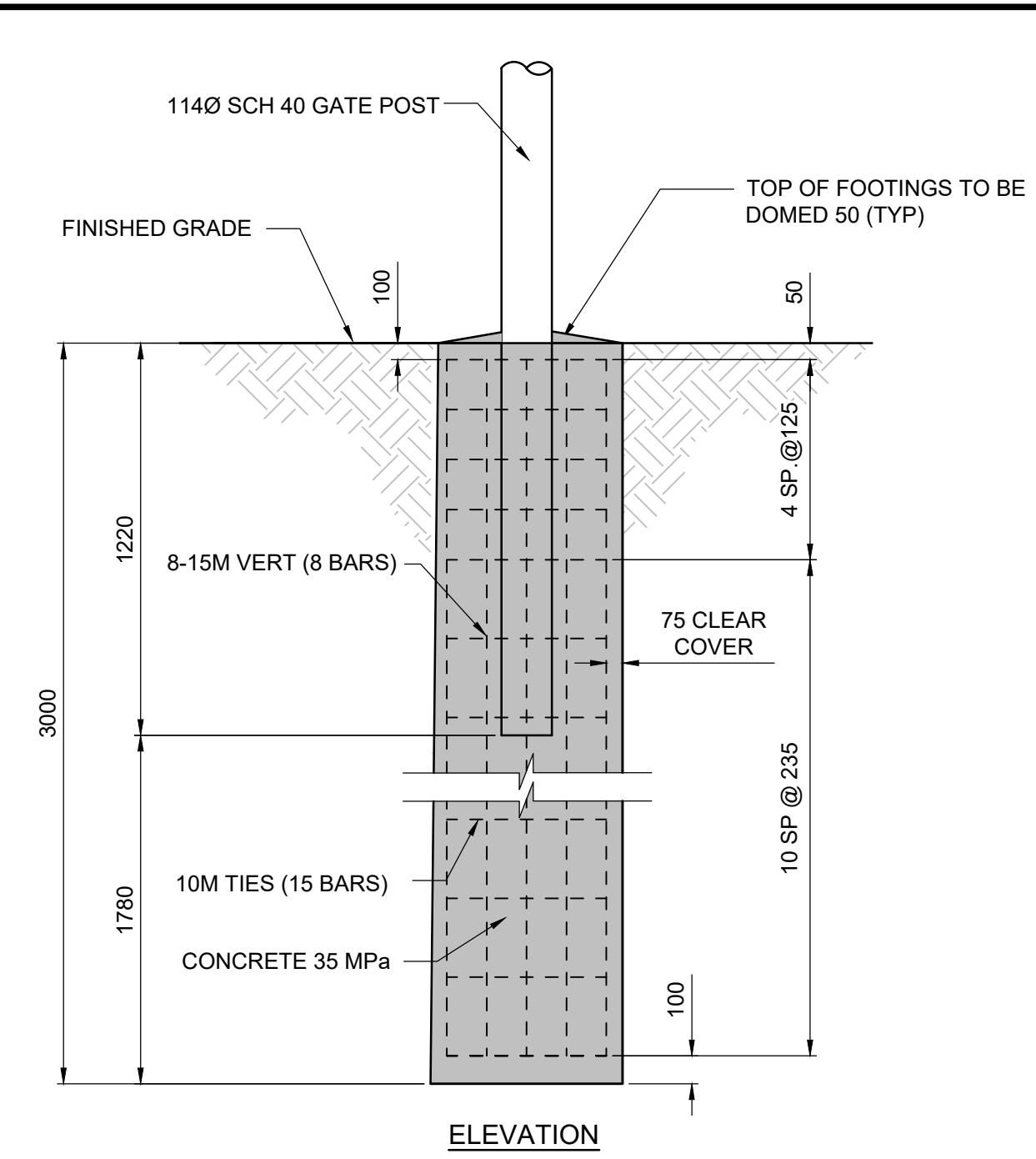

**3** CONCRETE PILE FOUNDATION FOR GATE POST  
NTS

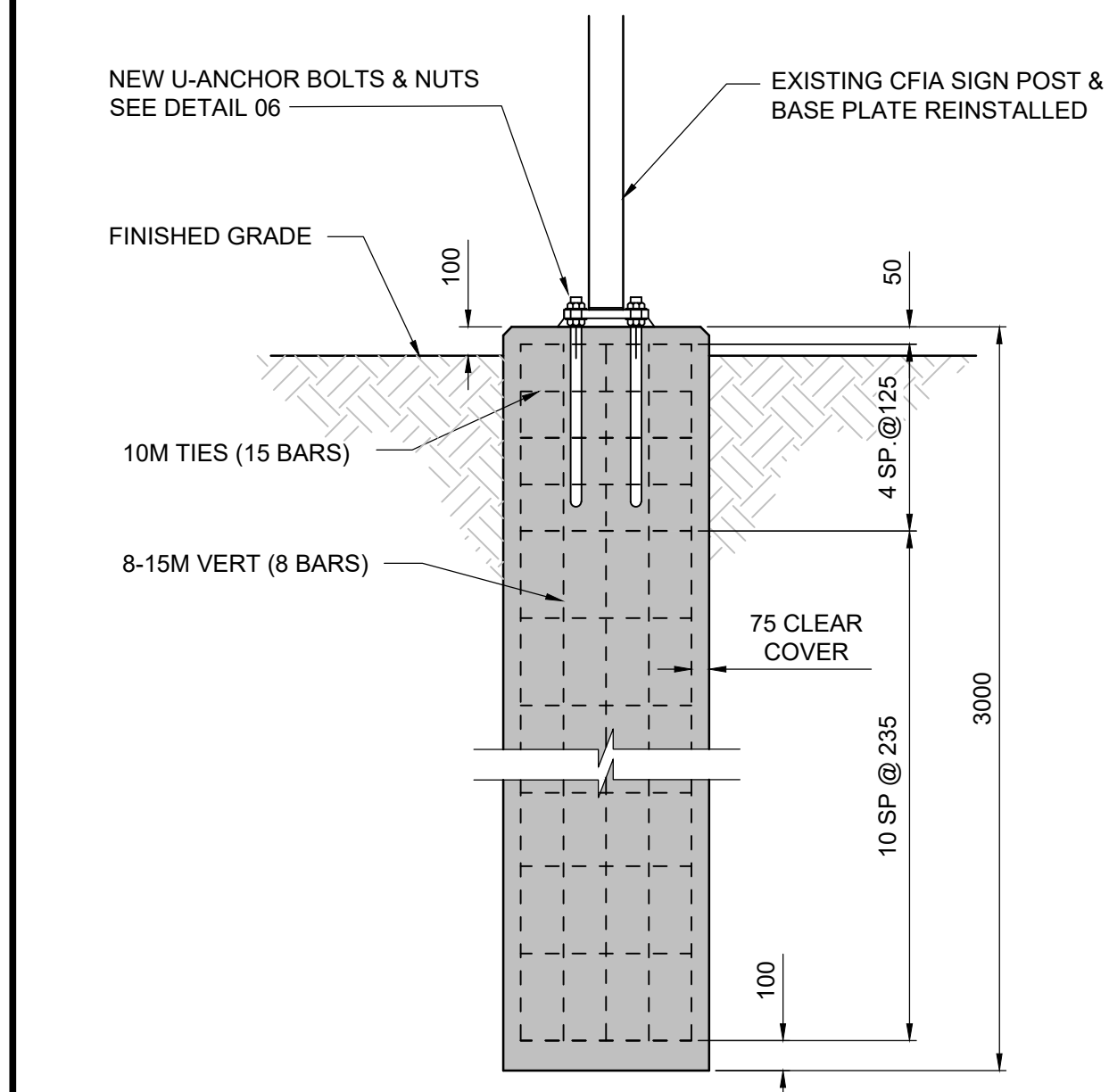

**4** CONCRETE PILE FOUNDATION FOR SIGN  
NTS

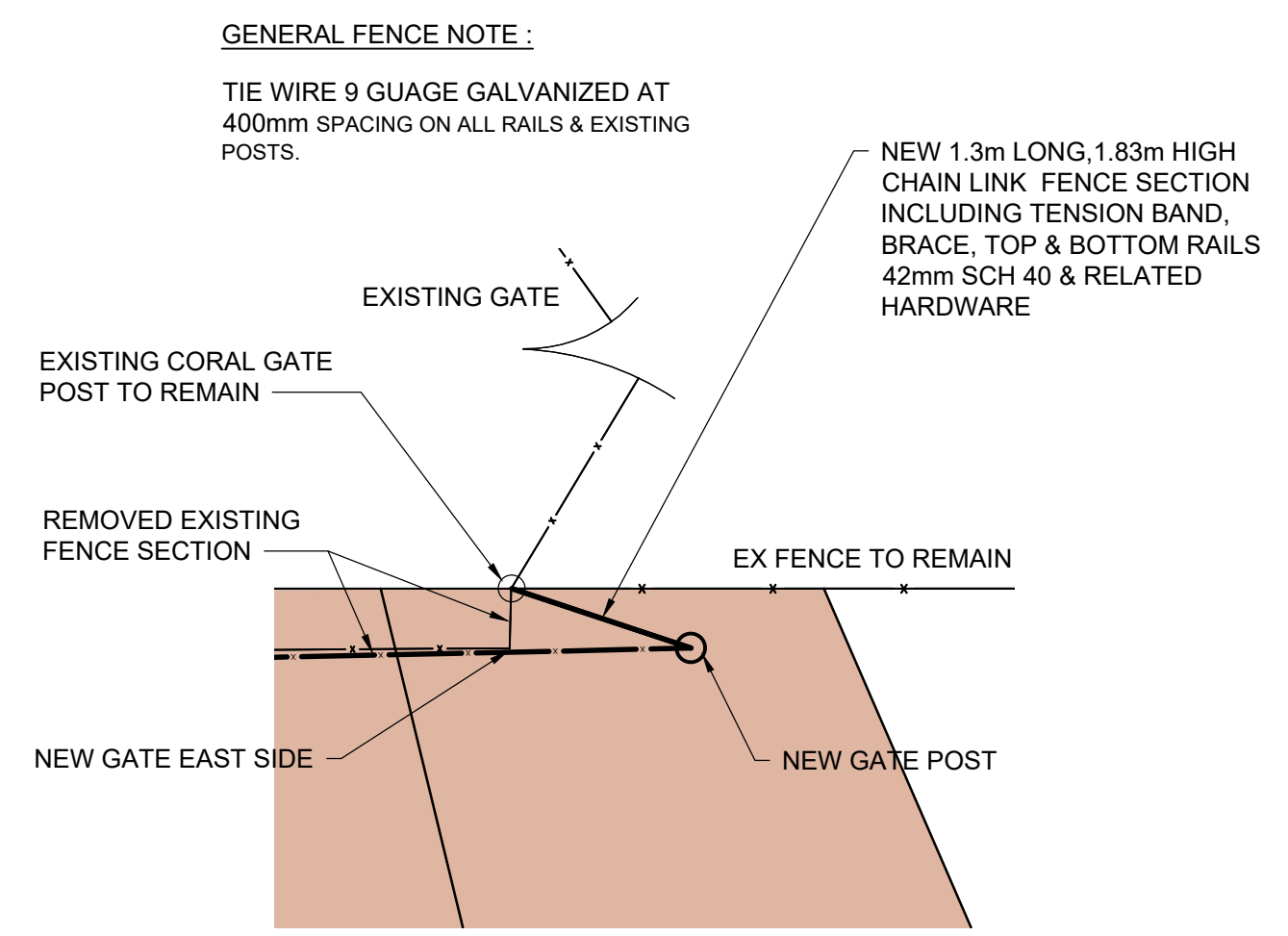

**5** CORAL GATE POST CONNECTION TO NEW GATE POST  
1:50

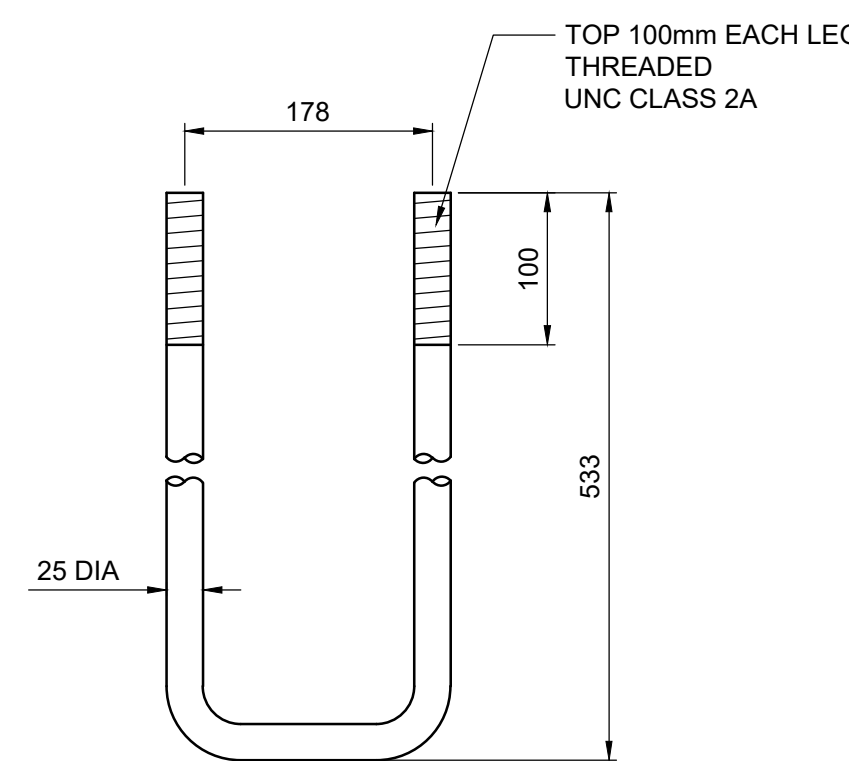

**6** ANCHOR BOLT LAYOUT & DETAILS  
NTS

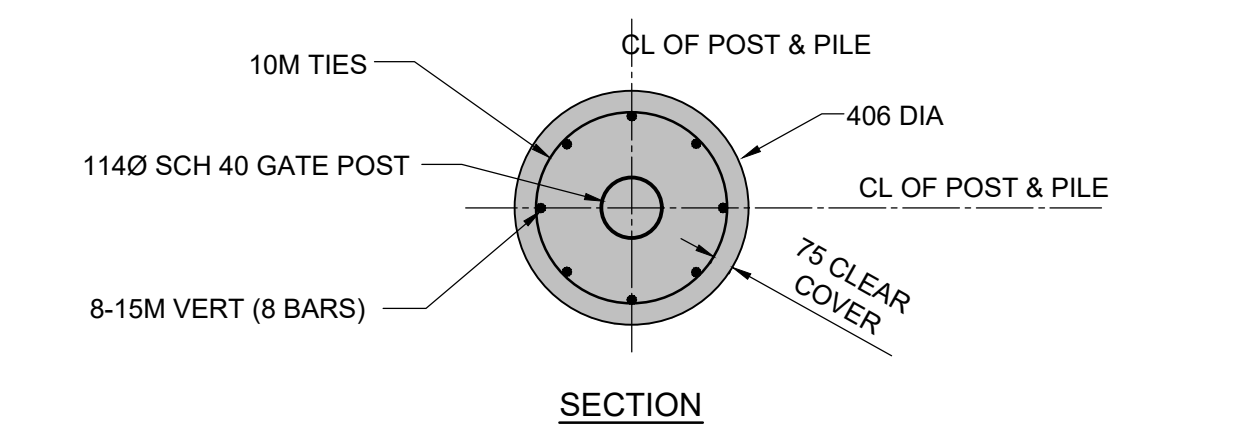

POST BASE DETAIL

- GENERAL NOTES**
- A. THESE DRAWINGS ARE COLOR CODED. MUST BE VIEWED AND PRINTED IN COLOR.
  - B. READ IN CONJUNCTION WITH SPECIFICATIONS AND RELATED ANNEXES.
  - C. UNLESS OTHERWISE INDICATED AS EXISTING, ALL MATERIALS TO BE PROVIDED ARE NEW AND TO BE SUPPLIED AND INSTALLED AS PART OF THIS CONTRACT.
  - D. DO NOT SCALE DRAWINGS. ALL DIMENSIONS AND QUANTITIES OF EXISTING MATERIALS MUST BE SITE VERIFIED BEFORE COMMENCING ANY WORK. ANY CLAIMS FOR ADDITIONAL COMPENSATION MUST BE RESOLVED BEFORE ANY WORK COMMENCES.
  - E. UNLESS OTHERWISE INDICATED, ALL REMOVED MATERIALS NOT INDICATED TO BE RE-INSTALLED MUST BE DISPOSED OFF-SITE IN ACCORDANCE WITH MUNICIPAL AND PROVINCIAL REGULATIONS. REFER TO SPECIFICATIONS SP.0 FOR WASTE MANAGEMENT PLAN. THERE IS A REQUIREMENT TO DIVERT, SEPARATE AND RECYCLE ALL WASTE WHERE POSSIBLE.
  - F. CONTRACTORS ARE RESPONSIBLE FOR REQUESTING CLARIFICATIONS DURING TENDERING AND CONSTRUCTION.
  - G. ENVIRONMENTAL MITIGATIONS MUST BE IMPLEMENTED AT ALL TIMES. REFER TO SPECIFICATIONS SP.0 ENVIRONMENTAL MANAGEMENT FOR THE ENVIRONMENTAL MITIGATIONS THAT THE CONTRACTOR IS REQUIRED TO IMPLEMENT FOR THIS PROJECT.
  - H. REFER TO SUBMITTALS LIST IN APPENDIX B OF SPECIFICATIONS. REFER TO SPECIFICATIONS SP.0 FOR SUBMITTAL PROCESS AND TIMELINES. SUBMITTALS MUST BE APPROVED BEFORE WORK COMMENCES.
  - I. MAINTAIN, PROTECT AND MAKE GOOD ON ALL SPACES ADJACENT TO THE WORK AREA, ON THE PROPERTY AND ON ANY NEIGHBORING PROPERTIES INCLUDING MUNICIPAL ROADS.
  - J. DO NOT TRAVEL UPON OR USE ANY SPACE ON THE ADJACENT PRIVATELY OWNED PROPERTY TO THE WEST.
  - K. PROVIDE UTILITY LOCATES BEFORE COMMENCING WORK. CONTACTOR IS RESPONSIBLE FOR COORDINATING AND COSTS.
  - L. PROVIDE 3RD PARTY INDEPENDENT INSPECTION AND TESTING AS OUTLINED IN SP.0. CONTACTOR IS RESPONSIBLE FOR COORDINATING AND COSTS.
  - M. PLAN AND DO OTHER DEMOLITION AND REMOVAL AS NEEDED TO FACILITATE NEW CONSTRUCTION.
  - N. PROVIDE BARRICADES AROUND THE ACCESS POINTS TO THE AREA OF CONSTRUCTION, AS NEEDED, FOR SAFETY.
  - O. REFER TO SPECIFICATIONS SP.0 SECTION 1.3 FOR WORK RESTRICTIONS THAT APPLY TO THIS PROJECT.
  - P. PROVIDE TEMPORARY FENCE PANELS AT LEAST 2.0 METERS HIGH FOR AREAS OF THE DEMOLISHED EXISTING FENCE INTERIM TO COMPLETION NEW GATE AND FENCE WORKS. THE TEMPORARY FENCE PANELS MUST BE SECURED TOP AND BOTTOM AND TO THE EXISTING FENCE TO REMAIN.

**METRIC**  
WHOLE NUMBERS ARE IN MILLIMETRES  
DECIMALIZED NUMBERS ARE IN METRES

DRAWING NO.	DESCRIPTION	NO.	DATE	DESCRIPTION	DRAWN	REVIEWED	ISSUED	APPROVED
1	ISSUED FOR TENDER		2022.11.30		GMD	DAL	DAL	JW
REVISIONS/ISSUE					DRAFTING	ENGINEERING		

PERMIT STAMP	SEAL
	ORIGINAL DRAWING REVISION "1" SEALED BY J.S. BETKE 2023.06.14

DESIGNED BY: DAL	DRAWN BY: GMD	REVIEWED BY: MH	CLIENT:
APPROVED BY: JW	DATE: 2023-06-14	SCALE: AS NOTED	Public Works and Government Services

PROJECT NAME: CANADIAN FOOD INSPECTION AGENCY - EMERSON, MB. NEW VEHICLE ACCESS
DRAWING DESCRIPTION: NEW WORKS - DETAILS
PROJECT NO.:
SHEET NO. C03
REV. 1

D:\22' x 34'

3D MODEL REF No: