

DATE: 2024-01-12 14:08 FILE: X:\2531\2531-0366-00 Finlay Bridge\07_DRAWINGS\01_Sheets\C101\C101.dwg

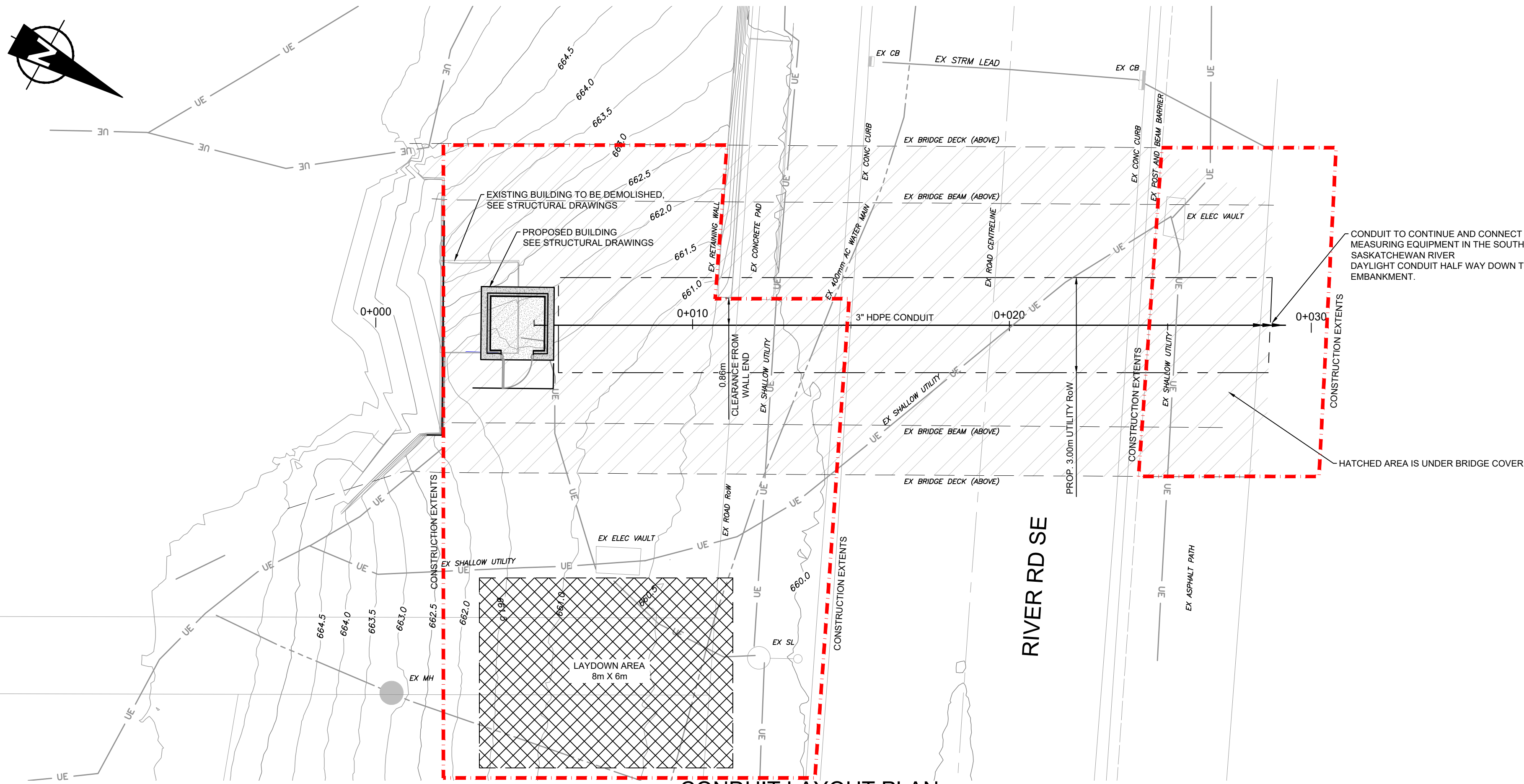

CONDUIT LAYOUT PLAN

SCALE 1:100

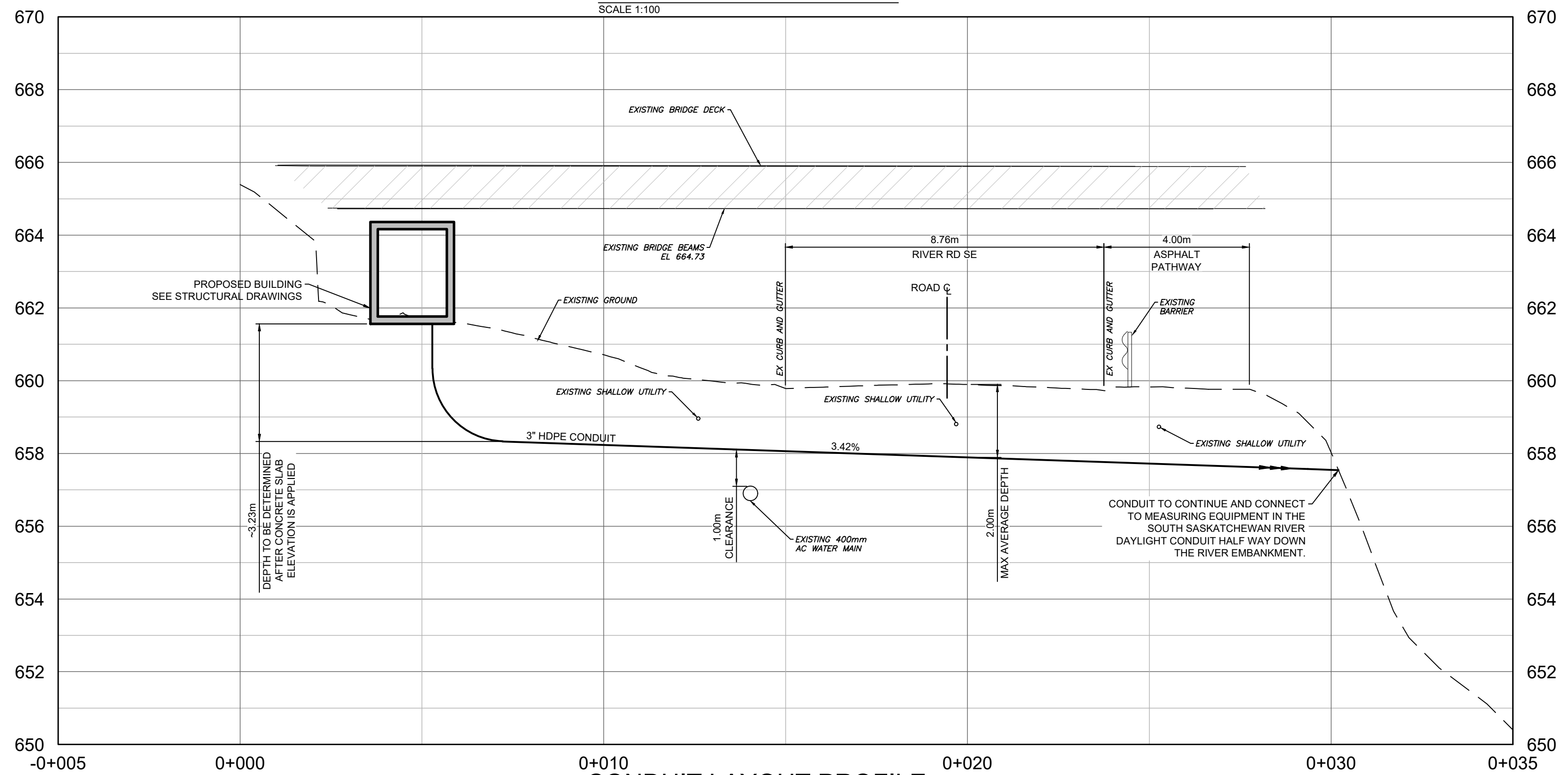

CONDUIT LAYOUT PROFILE

SCALE 1:100

Environment and Climate Change Canada
Environnement et Changement climatique Canada



Suite 203
 502 Bow Valley Trail
 Canmore AB
 Canada T1W 1N9
 T 403 608 3992

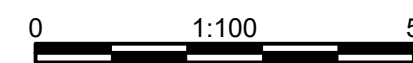

Rev	Date	Description	Drawn	Design	App'd
PD	2024-01-12	ISSUED FOR TENDER	NL	DM	AI
PC	2024-01-05	ISSUED FOR REVIEW	NL	DM	AI
PB	2023-11-17	ISSUED FOR REVIEW	NL	DM	AI
PA	2023-10-27	ISSUED FOR REVIEW	SS	DM	AL

ENVIRONMENT AND CLIMATE CHANGE CANADA
 220 4 AVE SE - SUITE 854, CALGARY, AB T2G 4X3

**FINLAY BRIDGE RETAINING WALL
 ENGINEERING DESIGN SERVICES
 HDPE CONDUIT PLAN AND PROFILE**

Drawing No.
C101
 Project Number
 2531-36606-00
 Rev.
 PD

NOTES:

- UTILITY CONFLICTS TO BE IDENTIFIED BY COMPLETING UTILITY LOCATES AND SITE VISITS.
- EXISTING UTILITIES TO BE DAYLIGHTED VIA HYDROVAC TO CONFIRM DEPTH AND ALIGNMENT PRIOR TO HDD.
- AT LEAST 1m CLEARANCE** REQUIRED FROM BOTTOM OF DRILL REAMER TO TOP OF EX. WATER MAIN.
- ALBERTA ONE CALL TO BE COMPLETED TO DETERMINE ACCEPTABLE CROSSING/PROXIMITY PROCEDURES AND METHODS.
- UTILITY RIGHT OF WAYS TO BE RESPECTED. ITEMS NOT PERMITTED WITHIN INCLUDE BUT ARE NOT LIMITED TO STRUCTURES, FENCES, AND TREES.
- EXCAVATIONS THAT AFFECT INTEGRITY OF EXISTING INFRASTRUCTURE NEED A MITIGATION PLAN (I.E. RELOCATION, TEMPORARY SUPPORTS, ETC).
- NO DECREASE IN GRADE AROUND BASE OF ELECTRICAL POLE OR CHANGE IN GRADE GREATER THAN 0.5m INCREASE UNDER OVERHEAD ELECTRICAL CONDUCTORS ALLOWED.
- CONTRACTOR TO CONTACT **JORDAN DUNCAN (PARKS AND RECREATION)** AND A PRIMARY PARKS AND RECREATION CONTACT WILL BE ASSIGNED.
- PARKING OF VEHICLES OR EQUIPMENT NOT PERMITTED ON PARK AREA OR BOULEVARD UNLESS IDENTIFIED AS PART OF CONSTRUCTION ZONE OR LAYDOWN AREA. PARKING OF VEHICLES OR EQUIPMENT NOT PERMITTED OUTSIDE OF CONSTRUCTION ZONE OR LAYDOWN AREA.
- CONTRACTOR RESPONSIBLE FOR OBTAINING VEHICLE ACCESS PERMIT THROUGH <https://forms.medicinehat.ca/Parks-And-Rec/Vehicle-Access-Permit> (CONTACT Parks@medicinehat.ca FOR FURTHER INFORMATION).
- VEHICLE ACCESS PERMIT TO BE SUBMITTED FOR REVIEW AND APPROVAL A MINIMUM OF TEN BUSINESS DATES PRIOR TO SCHEDULED START DATE OF WORK.
- CONTRACTOR TO PROVIDE PRE-ACCESS PHOTOGRAPHS TO DOCUMENT EXISTING CONDITIONS AND EXISTING DAMAGES.
- CONTRACTOR RESPONSIBLE FOR ARRANGING POST-CONSTRUCTION INSPECTION BY CONTACTING THE PARKS AND RECREATION REPRESENTATIVE.
- LAYDOWN AREA IS IN AREA MANAGED BY PARKS AND RECREATION. DEPARTMENT LIAISON SHOULD BE CONTACTED TWO WEEKS IN ADVANCE TO REVIEW TERMS AND CONDITION FOR USE.
- CONSTRUCTION/WORK TO BE LIMITED TO OUTLINED CONSTRUCTION EXTENTS.
- IRRIGATION LOCATES TO BE REQUESTED FROM **ELDEN ROTH, IRRIGATION FOREMAN THROUGH PARKS AND RECREATION GENERAL NUMBER (403) 529-8333** A MINIMUM OF 3 WORKING DAYS IN ADVANCE OF START OF PROJECT.
- IF THE IRRIGATION SYSTEM NEEDS TO BE TURNED OFF DURING CONSTRUCTION, CONTRACTOR TO CONTACT **PARKS AND RECREATION OPERATIONS USING GENERAL NUMBER (403) 529-8333** A MINIMUM OF 3 WORKING DAYS IN ADVANCE TO TURN OFF IRRIGATION. A PROPOSED SCHEDULE FOR DURATION IRRIGATION SYSTEM WILL BE TURNED OFF SHALL BE PROVIDED. TIME SHUT OFF SHOULD BE MINIMIZED TO LIMIT DRY PERIODS.
- CONTRACTOR TO RESTORE IRRIGATION STEMS INFRASTRUCTURE TO ORIGINAL CONDITION. ANY REPAIRS NEEDED AS A RESULT OF CONSTRUCTION ACTIVITIES TO BE DONE BY QUALIFIED IRRIGATION CONTRACTORS WITH EXPERIENCE WORKING ON THE CITY OF MEDICINE HAT IRRIGATION SYSTEMS AND SHALL BE COMPLETED AS PER THE DEPARTMENTS APPROVED SPECIFICATIONS (LOCATED ON CITY WEBSITE). CONTRACTOR TO CONTACT PARKS AND RECREATION TO REVIEW POTENTIAL CONTRACTOR QUALIFICATIONS AND TO DISCUSS PLANNED METHODOLOGY AND MATERIALS FOR REPAIRS.
- IRRIGATION REPAIRS TO BE INSPECTED BY PARKS AND RECREATION IRRIGATION STAFF PRIOR TO BACKFILL. PARKS AND RECREATION TO BE NOTIFIED A MINIMUM OF TWO WORKING DAYS IN ADVANCE OF FINAL IRRIGATION REPAIRS SO SYSTEM CAN BE TESTED PRIOR TO LANDSCAPE RESTORATION. PARK AND RECREATION TO BE NOTIFIED TO TURN IRRIGATION BACK ON AFTER LANDSCAPE RESTORATION.
- ENSURE SAFETY SIGNAGE IN PLACE FOR PUBLIC/PARK USERS ACCESS DURING CONSTRUCTION.
- CONTRACTOR TO MEET FOLLOWING REQUIREMENTS REGARDING REMEDIATION OF MANICURED TURF AREA AFFECTED BY CONSTRUCTION:

- DISTURBANCES TO BE SODDED UNLESS APPROVAL RECEIVED FROM DEPARTMENT REPRESENTATIVE TO HYDROSEED.
- 6 INCHES OF AMENDED TOPSOIL TO BE PLACED PRIOR TO INSTALLATION OF SOD.
- CONTRACTOR TO BE RESPONSIBLE FOR MOWING/WATERING/MAINTAINING/MONITORING CONDITION OF SOD UNTIL ACCEPTANCE BY PARKS AND RECREATION.
- FULL RESTORATION SHOULD FOLLOW CITY OF MEDICINE HAT PARKS AND RECREATION SPECIFICATIONS (<https://www.medicinehat.ca/en/business-and-development/construction-standards-and-specifications.aspx>)
- LANDSCAPE AREAS TO BE MAINTAINED ACCORDING TO SECTION 1.6 OF MAINTENANCE AND GUARANTEE SPECIFICATIONS. REQUIREMENTS FOR ACCEPTANCE IN SECTION 2.6 (<https://www.medicinehat.ca/en/business-and-development/resources/Documents/Standards-and-Specifications/MaintenanceGuarantee.pdf>)

- CONDUIT TO BE INSTALLED THROUGH DIRECTIONAL DRILLING.
- CONTRACTOR TO CONTACT **MELANIE KEELER (MELKEE@medicinehat.ca)** FOR FINAL AGREEMENT FOR INSTALLING NEW STATION WITHIN THE ROAD RoW.
- CONTRACTOR TO CONTACT **SAFETY CODE SERVICES - GARY (garchr@medicinehat.ca or (403) 977-0853)** FOR REVIEW OF ANY ELECTRICAL REQUIREMENTS. CONTRACTOR TO COORDINATE WITH **UTILITY DISTRIBUTION SERVICES - ELECTRIC** IF ANY UPGRADES OR ALTERATIONS TO THE EXISTING SERVICE ARE REQUIRED TO REVIEW THE PRIMARY SERVICE.

SOUTH SASKATCHEWAN RIVER

RIVER RD SE

DESTROY ALL PRINTS BEARING PREVIOUS REVISION