

## **Part 1: Questions and Answers**

<b>Question 1</b>	<b>Can you provide a layout of the furniture within the rooms?</b>
<b>Answer 1</b>	<b>Yes, typically requirements that do not include Cat 1A do not have layouts included but we are able to provide sketches of the anticipated layouts. Please see amendment for details.</b>

<b>Question 2</b>	<b>In regards to Cat 1B items #1 and 2, would a laminate modesty panel also be acceptable?</b>
<b>Answer 2</b>	<b>Yes, laminate would be acceptable as long as it is able to match the finish of the worksurfaces and meets the same technical requirements as the requested modesty panels.</b>

<b>Question 3</b>	<b>Cat 1B item #3, would a laminate pedestal also be acceptable?</b>
<b>Answer 3</b>	<b>Yes, laminate would be acceptable as long as it is able to match the finish of the worksurfaces and meets the same technical requirements as the requested pedestals.</b>

<b>Question 4</b>	<b>Cat 1B item #1 &amp; 2, would C-legs be acceptable?</b>
<b>Answer 4</b>	<b>Yes, C-legs are acceptable.</b>

## **Part 2: Amendment to Solicitation**

### ANNEX C: Floorplans

#### INSERT:

#### **1.0 Work Station Types**

##### 1.1 Sixteen (16) Type 1 workstations;

Type 1 work stations consist of the following:

- Two Height Adjustable work surfaces arranged into an L-shape;
- One under the desk storage unit for documents and members personal effects.

##### 1.2 Three (3) Type 2 workstations;

Type 2 workstations consist of the following:

- Two fixed height work surfaces arranged into an L-shape
- May have one (1) under the desk storage unit for documents and members personal effects, see below images.

##### 1.3 Seven (7) Type 3 workstations;

Type 3 workstations consist of the following:

- Height adjustable desk unit that measures 5'6" x 2'
- One (1) under the desk storage unit for documents and members personal effects.

##### 1.4 One (1) Type 4 workstation;

Type 4 workstations consist of the following:

- Fixed height work surface measuring 42" x 24".
- One (1) under the desk storage unit for documents and members personal effects.

1.5 One oval meeting table that is 3'6" x 6'.

## 2.0 Building 1004 Furniture Layout Plan

2.1 Main bullpen. Seven (7) Type 1 workspaces

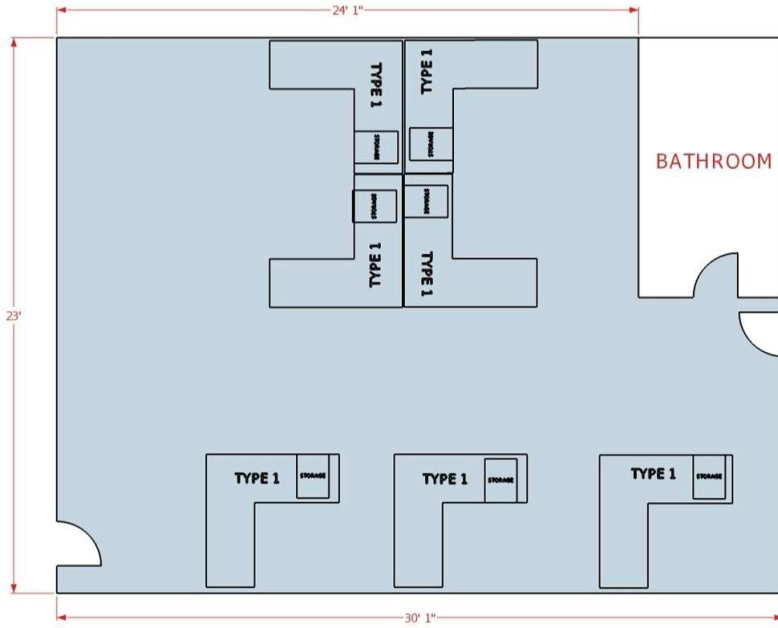

2.2 Office. Two (2) Type 1 workspaces

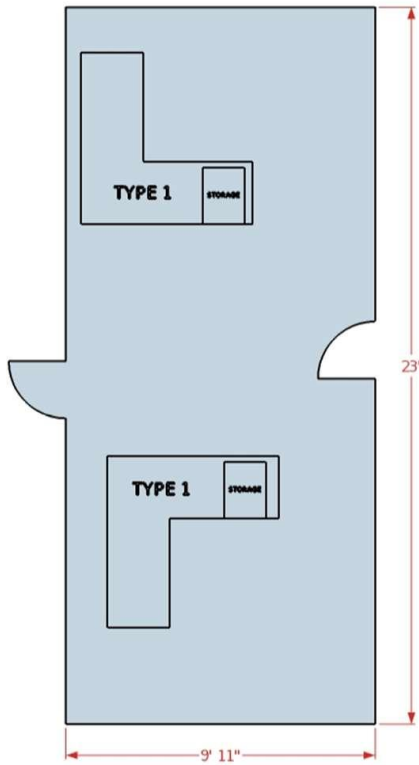

### 3.0 Building 1006 Furniture Layout Plan

3.1 Second Floor Commanding Officer's (CO) Office. One (1) Type 3 workspace, One (1) Type 4 workspace and one (1) oval meeting table

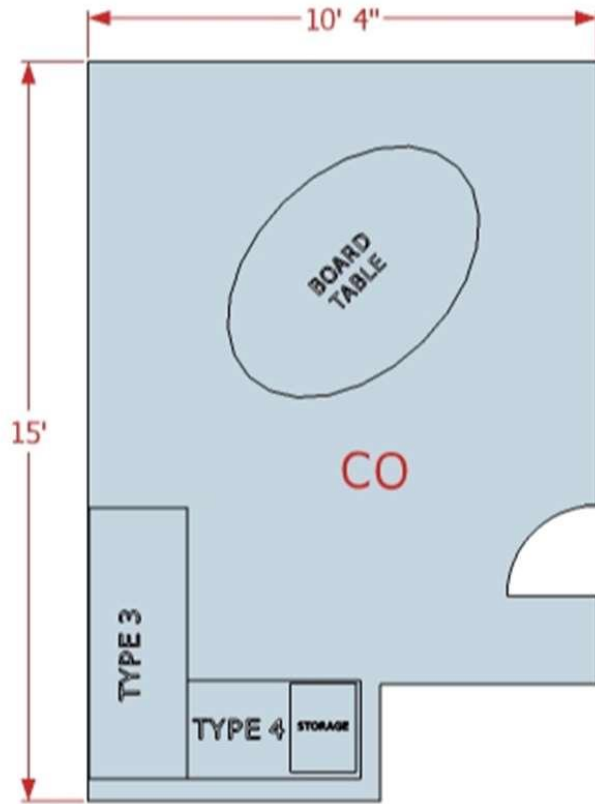

3.2 Second Floor Group Sergeant Major's (GSM) Office. One Type 3 workspace

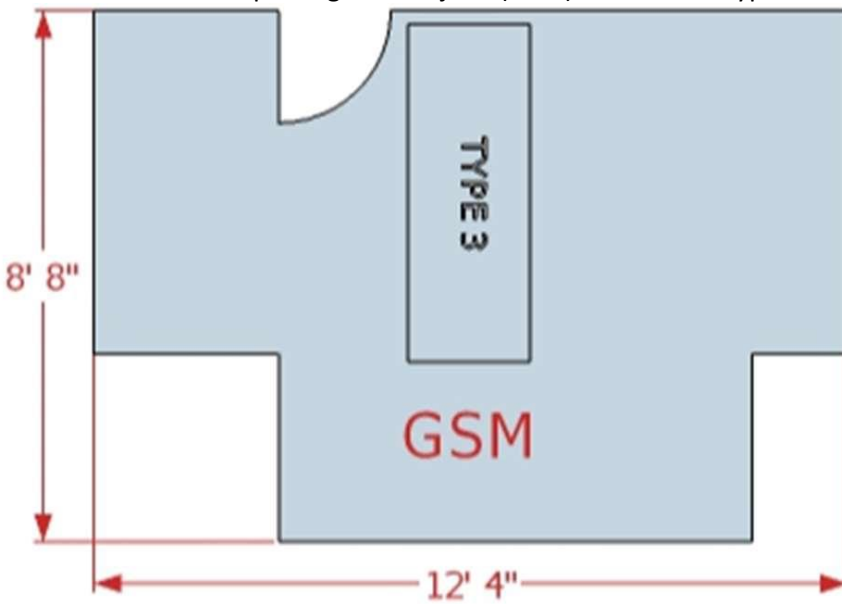

3.3 Second Floor hallway. One (1) Type 2 workstation

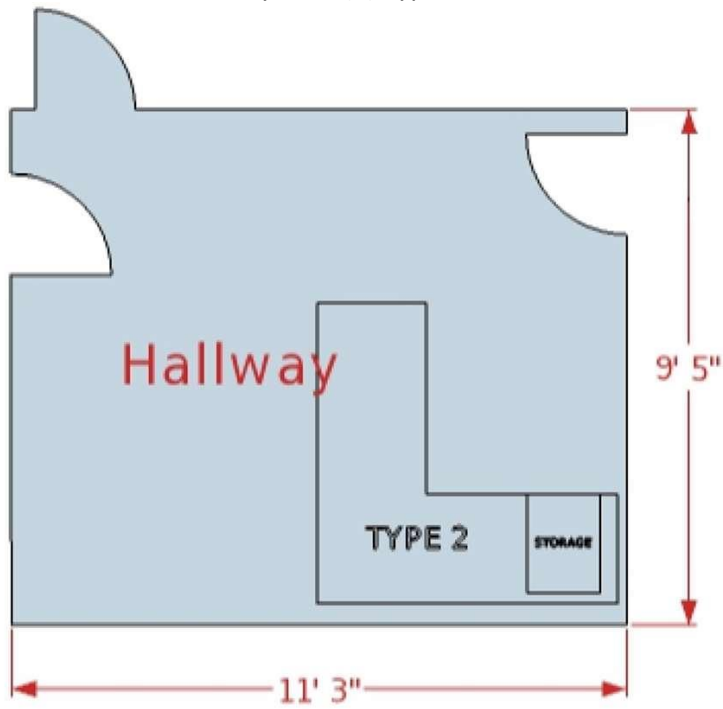

3.4 Second Floor Adjutant's Office. One (1) Type 1 workstation

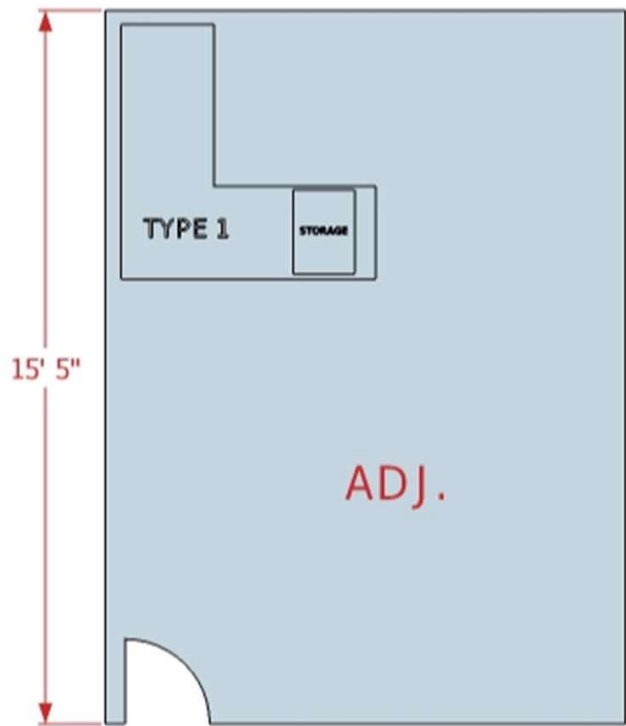

3.5 Second Floor Quartermaster Sergeant Instructor's (QMSI) Office. Two (2) Type 2 workstations.

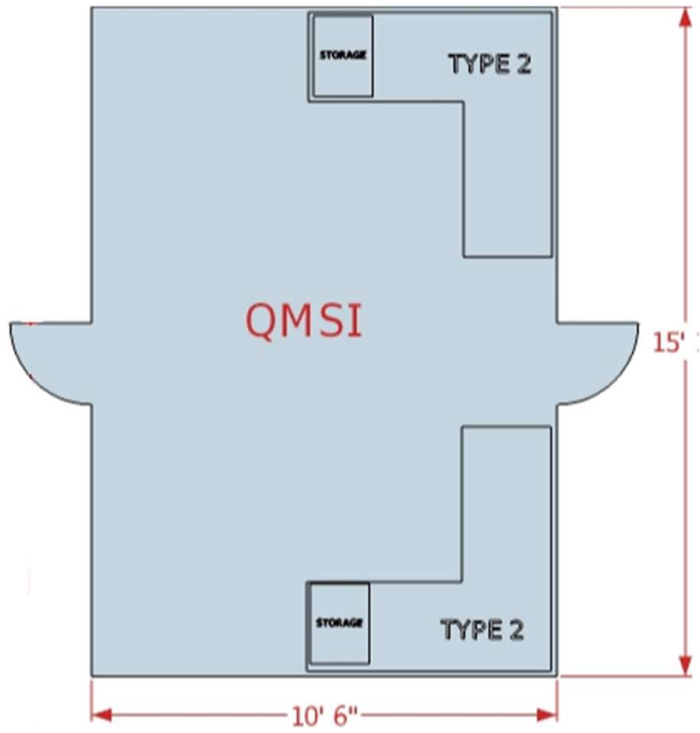

3.6 First Floor Logistics Cell. Two (2) Type 1 Workstations and one (1) Type 3 Workstation

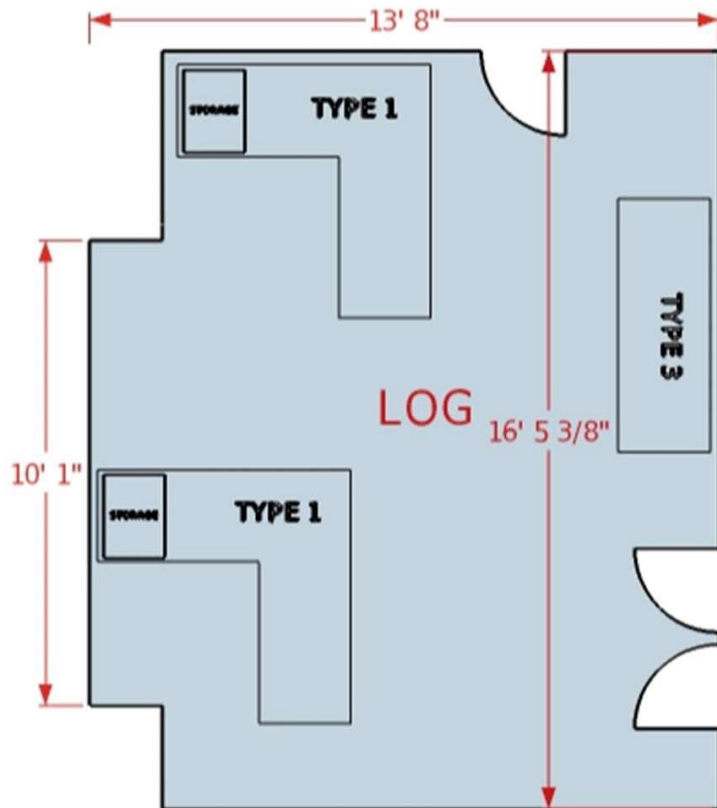

3.7 First Floor Operations (Ops) Cell. Two (2) Type 1 Workstations

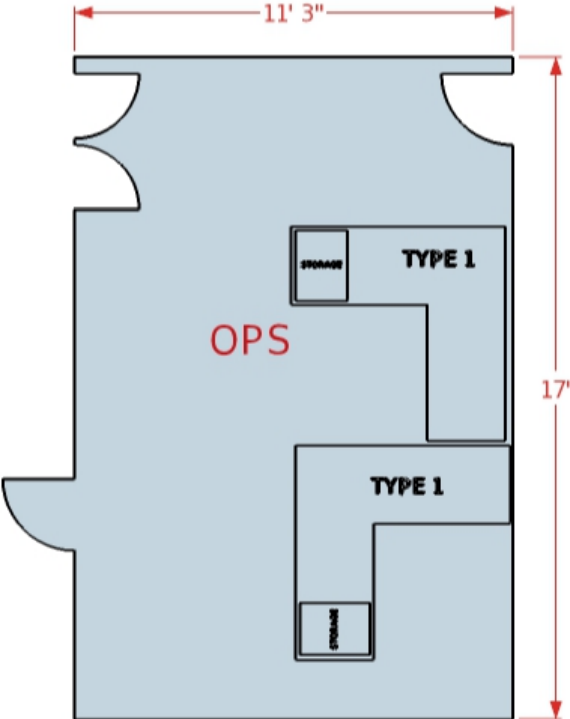

3.8 First Floor Ops Officer's (Ops O) Office. Two (2) Type 1 Workstations

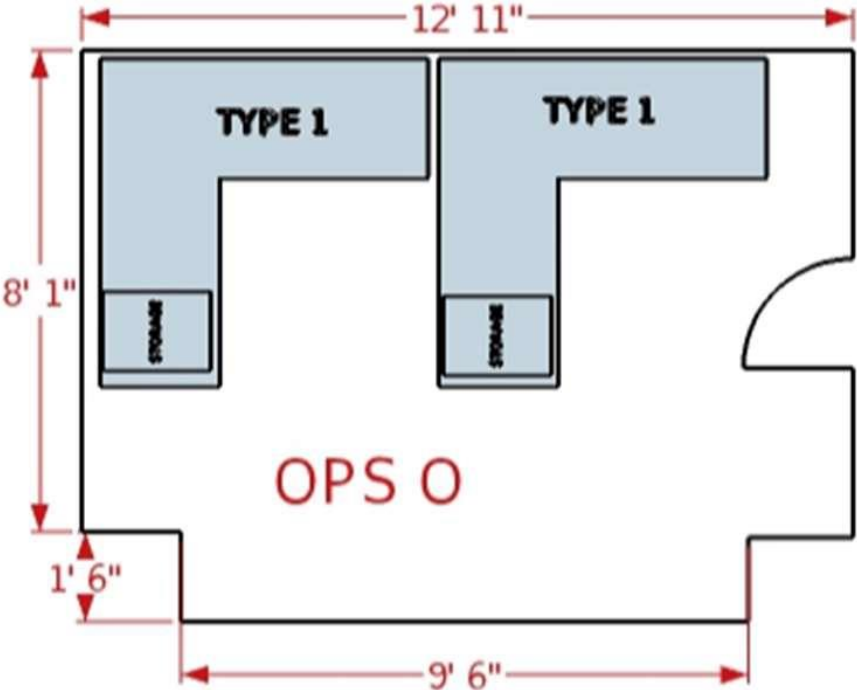

3.9 First Floor Finance Office. Three (3) Type 3 workstations.

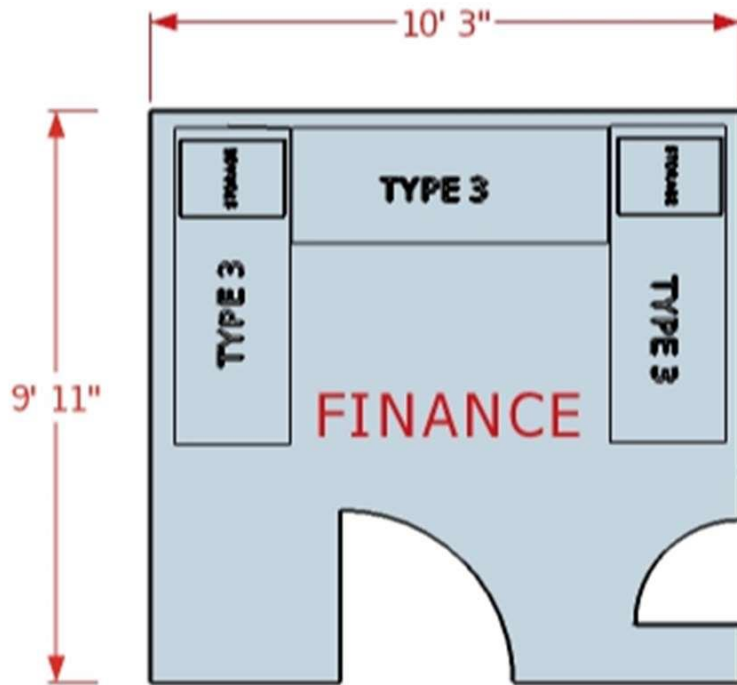

3.10 First Floor Pay Accounts Officer's (PAO) Office. One (1) Type 3 workstation.

